

SPA Load cells

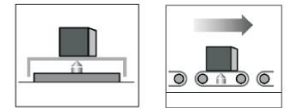
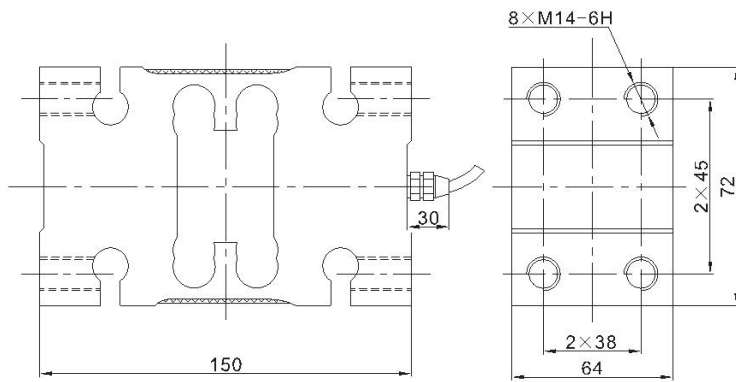

Specifications 技术说明 Exc+激励正 (Red,红);Exc-激励负(Black,黑);Sig+信号正(Green,绿);Sig-信号负(White,白)

Item 项目	Unit	Parameter					
		C 2	C 3				
Accuracy class to OIML R60 精度等级		C 2	C 3				
Maximum capacity (E_{max}) 额定载荷	kg	50,100,200,300,500,750					
Sensitivity (C_n) / Zero balance 灵敏度/零点平衡	mV/V	2.0 ± 0.2 / 0 ± 0.1					
Temperature effect on zero balance (TK ₀) 温度对零点影响	% of C _n /10K	± 0.0175	± 0.0140				
Temperature effect on sensitivity (TK _c) 温度对灵敏度影响	% of C _n /10K	± 0.0175	± 0.0140				
Hysteresis error (d _{hy}) 滞后误差	% of C _n	± 0.02	± 0.0150				
Non-linearity(d _{lin}) 非线性误差	% of C _n	± 0.0270	± 0.0167				
Creep(d _{cr}) over 30 min. 蠕变及蠕变恢复	% of C _n	± 0.0250	± 0.0167				
Eccentric error 四角误差	%	± 0.0233					
Input (R_{Lc}) & Output resistance (R_o) 输入&输出电阻	Ω	382 ± 15 & 352 ± 3					
Nominal range of excitation voltage (B_u) 额定电压	V	5~15					
Insulation resistance (R _{is}) at 50Vdc 绝缘电阻	MΩ	≥ 5000					
Service temperature range (B _{tu}) 工作温度	°C	-20...+50					
Safe load limit (E _L) & Breaking load(E _d) 安全承载&破坏载荷	% of E _{max}	120 & 200					
Protection class according to EN 60 529 (IEC 529) 保护等级		IP65					
Material :Measuring element 材料:测量元件		合金钢 Alloy Steel					
Maximum capacity (E _{max}) 额定载荷	kg	50	100	200	300	500	750
Min. load cell verification inter(v _{min}) 最小检定分度值	g	20	20	50	50	100	100
Maximum platform size 最大秤台尺寸	mm	800 × 800					
Deflection at E _{max} (s _{nom}), approx 最大载荷下的变形量	mm	< 0.6					
Weight(G), approx 重量	kg	4.3			4.5		
Cable 电缆: Diameter 直径: Ø5mm Length 长度	m	3m					
Mounting: Cylindrical head screw 装配: 内六角圆柱头螺钉		M14-10.9					
Tightening torque 螺丝紧固力矩	N. m	35N.m					